

大容量分块料斗

Bulk Hopper

自动定量分块料斗
Automatic Dosing and Portioning Hopper



Sveba-Dahlen大容量料斗，由光电传感器控制，自动定量分块，能够均匀准确地供料给分块机或者类似装置。

Sveba-Dahlen Bulk Hopper is a photocell controlled automatic dosing and portioning hopper that enables smooth and even dough feed into a divider or similar equipment.

产品特点和优势

- 料斗容量575升或约可容纳约300公斤面团
- 料斗上安装有2个光电传感器，可很好的控制切割和面团料位
- 可安装在可移动传输带上同时供给两条独立生产线
- 不锈钢材质
- 400mm气动面团切割刀

选项

- 不锈钢支架
- 独立的电箱
- 不沾涂层料斗
- 不沾涂层切割刀
- 带刮刀的面团输送带，水平安装在料斗底部
- 料斗润滑
- 安全防护罩可定制
- 料斗可定制

FEATURES AND BENEFITS

- Volume 575 liters or approximately 300 kg of dough capacity
- Two photocells mounted on the hopper for perfect control of cutting and dough level feed
- Can be mounted on movable racks for feeding two separate lines
- Bulk hopper in stainless steel
- 400 mm pneumatic controlled dough knife

OPTIONS

- Stainless steel frame
- Separate electrical cabinet
- Non-stick coated hopper
- Non-stick coated crossbar knife
- Dough conveyor with scraper – horizontally mounted under the Bulk hopper
- Hopper lubrication
- Customized safety guard
- Customized bulk hopper

技术参数 SPECIFICATIONS

BULK HOPPER

电源 POWER SUPPLY	1 X 230V 1 X 230V
压缩空气 COMPRESSED AIR	6 BAR 6 BAR

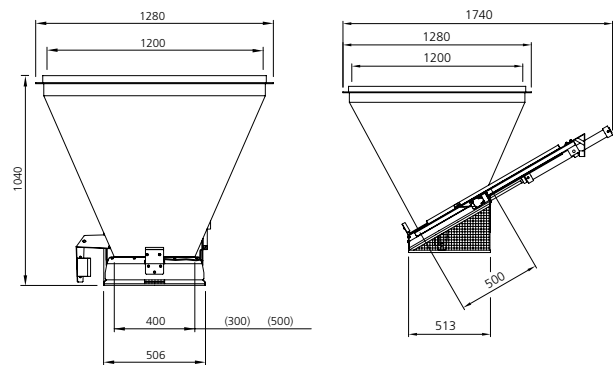

Better baking business.

A Member of the Sveba-Dahlen Group AB